

Land for Sale in St. Eustatius (Statia) Lodi District



\$ 190.000

4.000 m2

Other

Prime Development Land - English Quarter, St. Eustatius

An exceptional opportunity to acquire development land in the historic English Quarter area of St. Eustatius. This parcel offers a peaceful island setting with excellent potential for residential development or a private estate.

The property forms part of the Lodi district and is ideally positioned along the old road leading to Round Hill and English Quarter, providing convenient access while maintain...

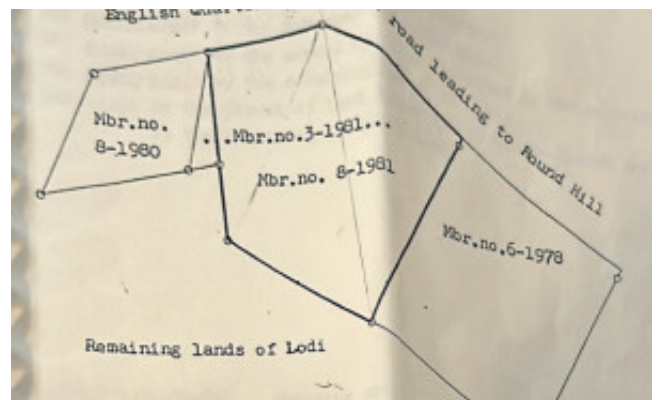

[Discover More online...](#)



Mandy Daal Offringa
Agent

7215875873

mdaaloffringa@kwsintmaarten.com

kww SINT
MAARTEN
KELLERWILLIAMS®